

# Uplands

www.deverevenues.co.uk

0870 609 1159

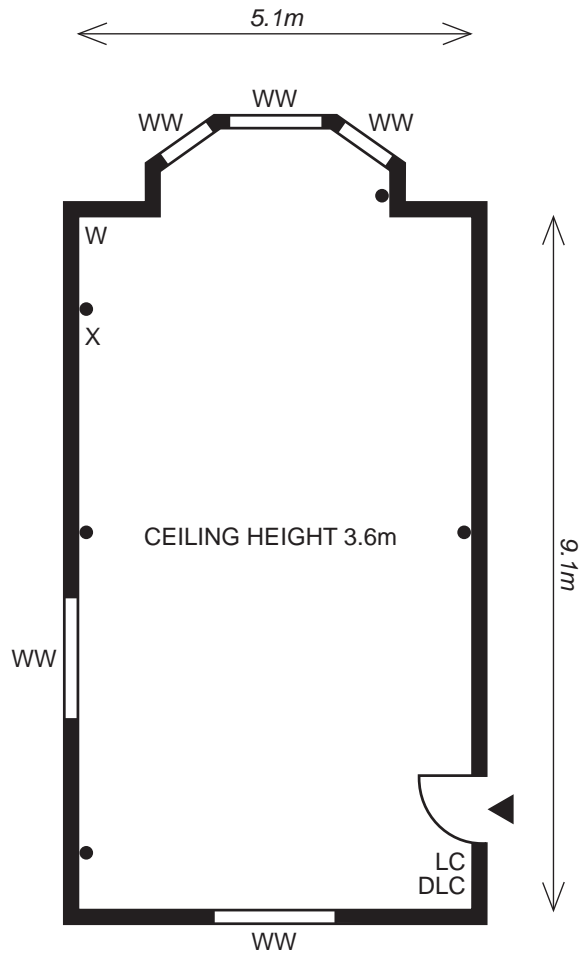

## HUGHENDEN

### KEY:-

|   |                             |
|---|-----------------------------|
| ▲ Entrance                              | ○ 3-Phase Power Point       |
| X Telephone                             | M Microphone Point          |
| • Double Power Point                    | DLC Dimmer Lighting Control |
| PSL Profile Spot Light - Ceiling Height | WW Window                   |
| LC Lighting Control                     | CS Coffee Station           |
| PA PA Control                           | W Water Dispenser/Cooler    |

### CAPACITIES

|              |                  |                        |
|--------------|------------------|------------------------|
| Theatre 25   | Cabaret N/A      | Cocktail Reception N/A |
| U-shape 16   | Classroom 16     | Fork Buffet N/A        |
| Boardroom 20 | Lunch Dinner N/A | Dinner Dance N/A       |

### ACCESS DETAILS

Door height 2m  
Door width 1m

### LIGHTING DETAILS

### OTHER FEATURES

Telephone Points 2

### CONFERENCE EQUIPMENT

Whiteboard  
Overhead Projector/Screen  
VHS Video and Monitor  
Flipchart  
Trainers Tool Box

*Specialist Conference Equipment can be ordered as required.*